

Rigid PVC Pipe and Fittings with anti water condensation layer for air conditioning drainage

ESLON® AC DRAIN PIPE

ESLON® AC DRAIN Fittings

ESLON® Transparent AC DRAIN Fittings

**No Insulation
Work Required!**



Most suitable piping material for air conditioning drainage is

Eslon AC Drain Pipe and Fittings prevent water condensation and do not require any insulation work. It is a perfect fit for air conditioning drainage in office, hotel and hospital, etc.

Problems

on conventional air conditioning drainage.

Eslon AC Drain Pipe & Fittings solve all problems!

Insulation work

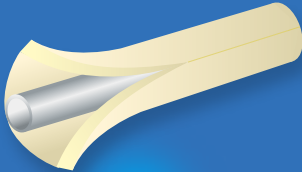

It is a time consuming for insulation work.

Secure the installation



Cannot check joint and slope angle.

Threading work



Threading is painful work.

Do not need insulation work

Eslon AC Drainage Pipe and Fittings have a function of thermal insulation. Therefore you do not need any insulation work.

Conventional Method

Multiple operations were required.

In case of Packaging Air Conditioning

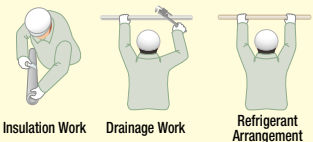

Insulation Work Drainage Work Refrigerant Arrangement

In case of Fan Coil Unit

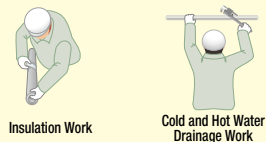

Insulation Work Cold and Hot Water Drainage Work

With AC Drain

Refrigerant, Drainage, Insulation Work,

Cold and Hot Water, Drainage and Insulation Work,

Multiple works can be eliminated.

AC Drains is effective to reduce installation time.

Easy to Install and Improve the Quality

Installation is identical to a conventional DV connection. There is no outer insulation material. Therefore, inspection work on joint and slope setting is much easy. In addition, visual inspection and securing the joint works are feasible by using Transparent Fittings.

Cost Saving

Eslon AC Drain Pipe and Fittings System is economical because of easy installation and elimination of insulation work.

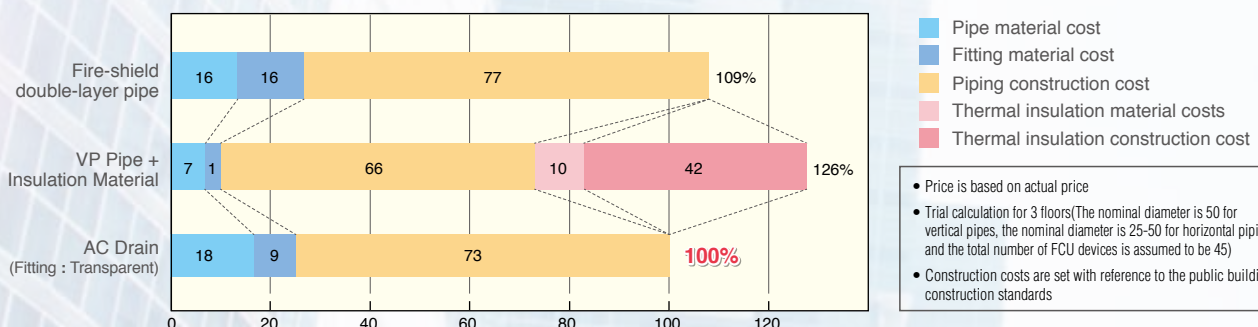

AC Drain Pipe and Fittings!

Water condensation is prevented by foamed layer.

Both Pipe and Fittings have a foamed insulation layer. This prevents whole plumbing from water condensation without having outer insulation material.

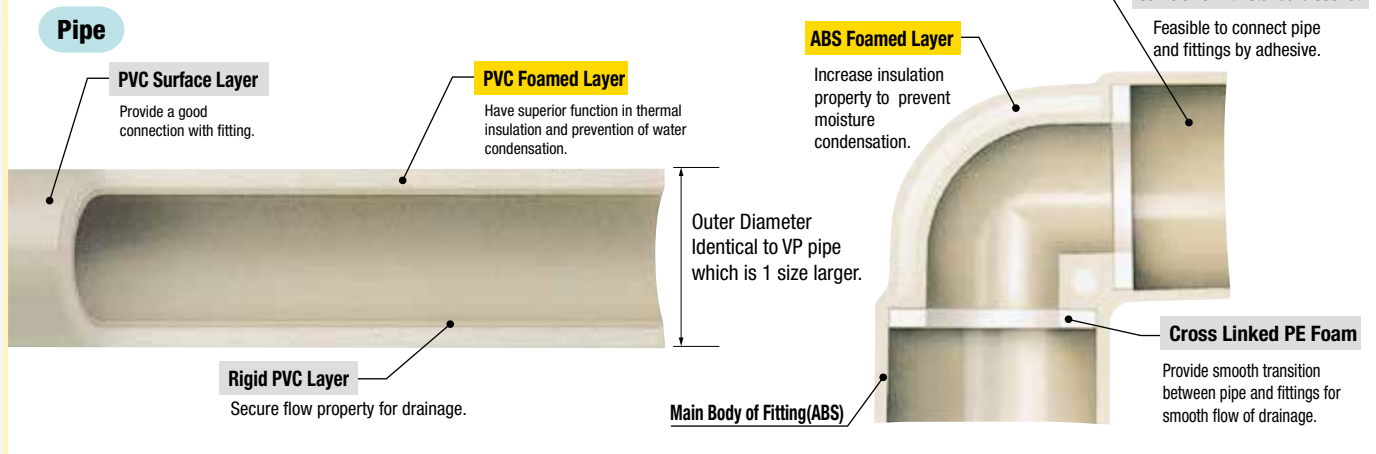

Can be applied for air conditioning drainage regardless whether the system is packaged air conditioner or fan coil unit.

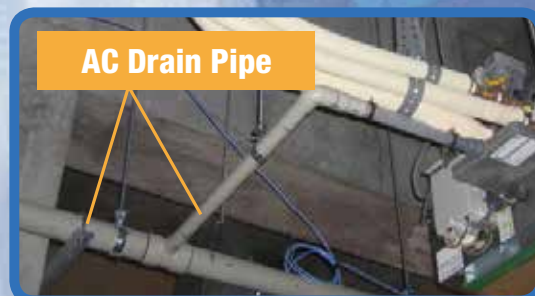
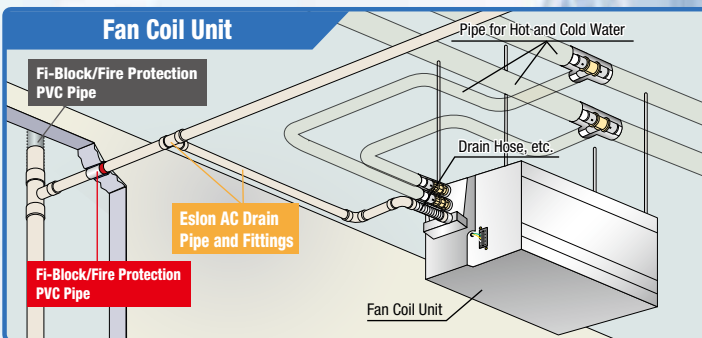
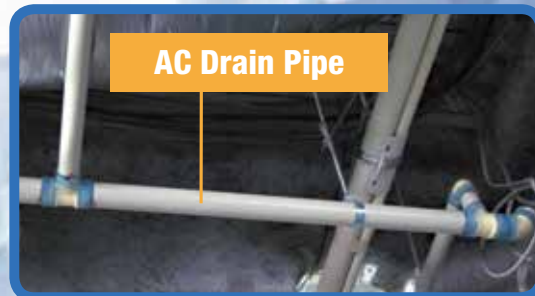
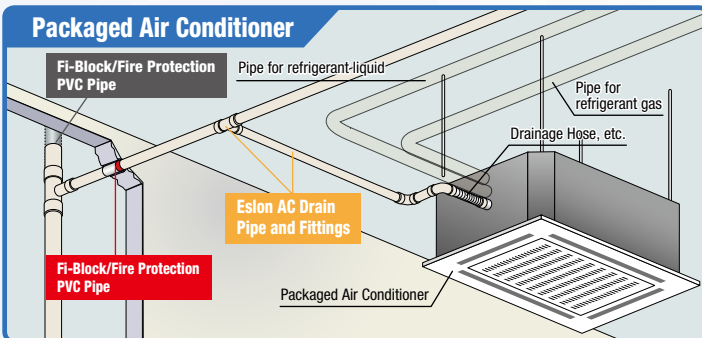

⚠ Arrange thermal insulation in principle for pump up section. Some conditions may not require, but please check and determine properly.

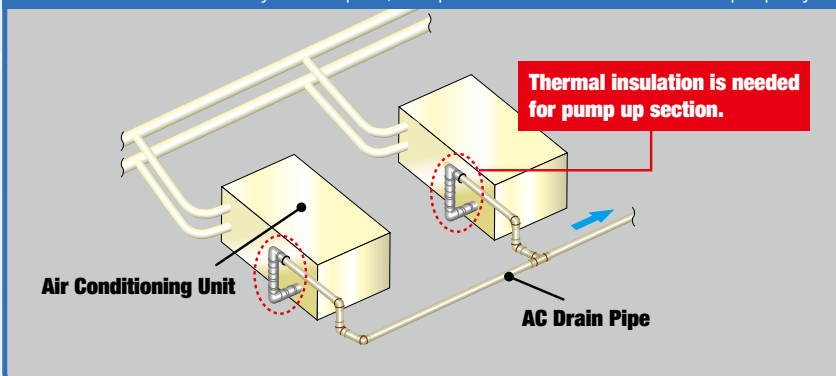

Applicable Range

Category	Condition
Application	for Air Conditioning Drainage
Water Pressure	Under no pressure (Note)
Water Temperature	Normal Temperature (5-35°C)
Nominal Diameter	20-50

Note: Except pump up whose length is less than 1 meter

Mark in this brochure

⚠ **Caution** In case left hand mark is stated, it may cause serious injury or burn wound unless properly treated.



Items with left hand mark is precaution statement to secure the performance of material



Transparent AC Drain Fittings

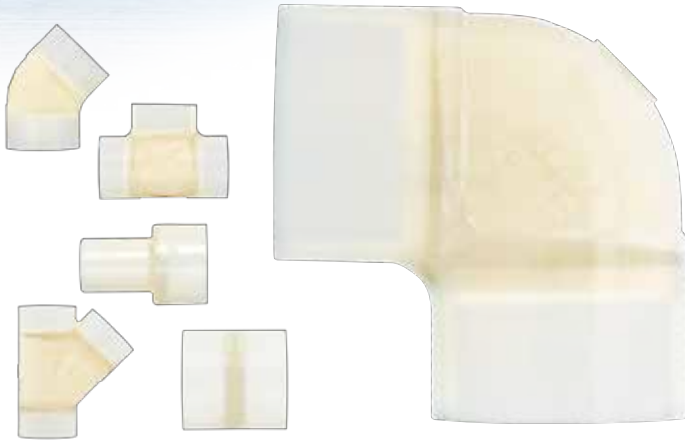
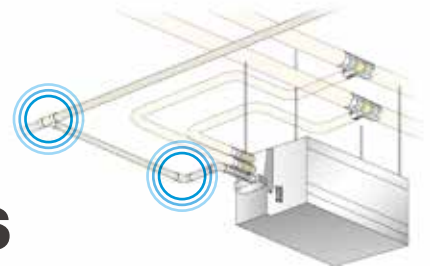

Structure

Transparent Material(ABS)

Easy to conduct visual check to avoid insufficient adhesive or insufficient insertion.

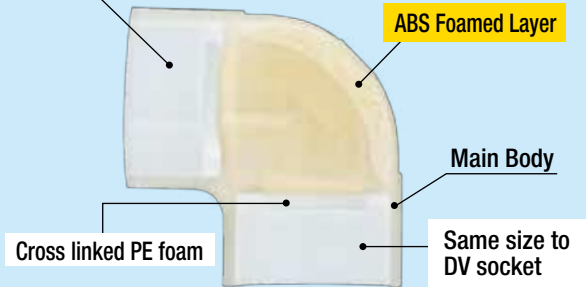

Easy to check connecting condition

Refer Page 4, 5, 6, 7 for product line and specification.

Feature

Proper connecting condition

Not inserted sufficiently

No adhesive was applied

In case of Adhesive Blue

Adhesive No. 73S Blue



Adhesive No. 75S Blue N



In case of luminous adhesive

NEW

Adhesive No.73S UV

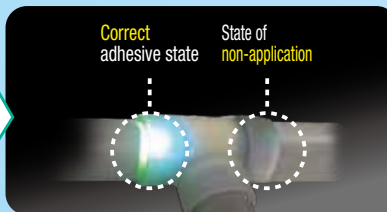

Be sure to use adhesive No.73S Blue, No.75S Blue N, or No.73S UV for transparent AC drain fittings.

Example of plumbing

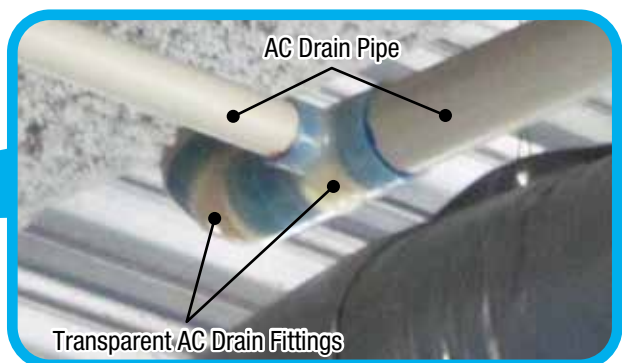

Eslon AC Drain Pipe and Fittings Product Lineup

Straight Pipe

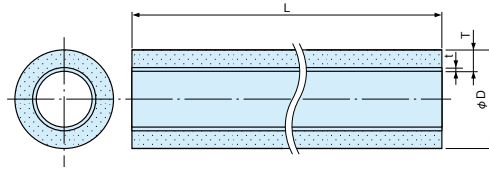

Munsell No. 2.5Y7.5/1

Unit:mm

Product Number	Nominal Diameter	Outer Diameter φD	Tube Thickness T	Thickness of Rigid PVC Layer t	Approximate inner diameter (reference)	Length L	Reference Mass (kg/m)	Quantity per Package	Price
ACD20P	20	32.0	6.5	1.7	19.0	4,000	0.32	16	3,450 yen
ACD25P	25	38.0	6.5	2.0	25.0		0.50	12	3,864 yen
ACD30P	30	48.0	8.5	2.0	31.0		0.72	9	4,830 yen
ACD40P	40	60.0	9.0	2.2	42.0		1.00	6	6,279 yen
ACD50P	50	76.0	9.5	2.5	57.0		1.41	4	8,211 yen
NEW ACD65P	65	89.0	10.0	2.6	69.0		1.77	4	11,286 yen

Fittings

Socket Dimensions (Common)

●Foam Injection Moldings

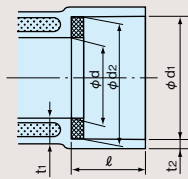

●Injection Molded Products

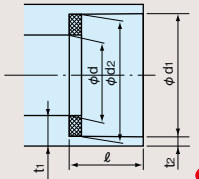

Nominal Diameter	Inner Diameter			Socket Length Z	Thickness t1 (minimum)	Socket Thickness t2 (minimum)
	φd1	φd2	φd			
20	32.25±0.25	31.85±0.25	19.0	23	8.5	2.7
25	38.25±0.25	37.85±0.25	25.0	23	8.5	2.7
30	48.30±0.30	47.80±0.30	31.0	27	0.7	2.7
40	60.35±0.30	59.75±0.30	42.0	30	9.1	3.1
50	76.40±0.30	75.70±0.30	57.0	40	9.4	3.1
NEW 65	89.45±0.30	88.65±0.30	69.0	44	10.0	3.6

Unit:mm

<ABS Foam Injection Molded Product>

90 °Elbow

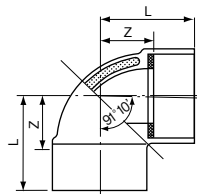

Nominal Diameter	Effective Length Z	Full Length L	Quantity per Package	Ivory Colored		Transparent	
				No.	Price	No.	Price
20	23	42	80	ACL20N	621 yen	ACL20S	713 yen
25	26	45	160	ACL25N	665 yen	ACL25S	759 yen
30	31	54	100	ACL30N	786 yen	ACL30S	909 yen
40	37	63	50	ACL40N	1,076 yen	ACL40S	1,242 yen
50	46	82	20	ACL50N	1,265 yen	ACL50S	1,461 yen
NEW 65	52	92	16	ACL65N	1,610 yen	ACL65S	1,850 yen

Unit:mm

45 °Elbow

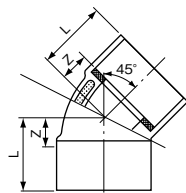
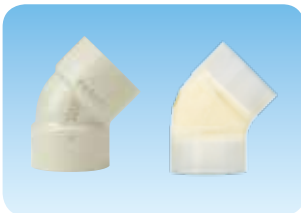

Nominal Diameter	Effective Length Z	Full Length L	Quantity per Package	Ivory Colored		Transparent	
				No.	Price	No.	Price
20	14	33	80	AC4L20N	621 yen	AC4L20S	713 yen
25	16	35	160	AC4L25N	665 yen	AC4L25S	759 yen
30	18	41	100	AC4L30N	786 yen	AC4L30S	909 yen
40	22	48	60	AC4L40N	1,076 yen	AC4L40S	1,242 yen
50	26	62	30	AC4L50N	1,265 yen	AC4L50S	1,461 yen
NEW 65	29	69	20	AC4L65N	1,610 yen	AC4L65S	1,850 yen

Unit:mm

Tees

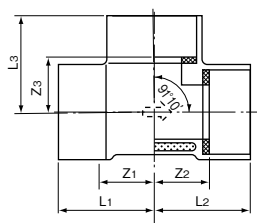

Nominal Diameter	Effective Length			Full Length			Quantity per Package	Ivory Colored		Transparent	
	Z1	Z2	Z3	L1	L2	L3		No.	Price	No.	Price
20	23	23	23	42	42	42	40	ACT20N	748 yen	ACT20S	851 yen
25	26	26	26	45	45	45	100	ACT25N	786 yen	ACT25S	897 yen
25×20	23	23	26	42	42	45	40	ACT251N	874 yen	ACT251S	1,001 yen
30	31	31	31	54	54	54	60	ACT30N	907 yen	ACT30S	1,035 yen
30×20	23	23	31	46	46	50	24	ACT302N	907 yen	ACT302S	1,035 yen
30×25	26	26	31	49	49	50	60	ACT301N	907 yen	ACT301S	1,035 yen
40	38	38	38	64	64	64	30	ACT40N	1,265 yen	ACT40S	1,461 yen
40×20	23	23	38	49	49	57	20	ACT403N	1,208 yen	ACT403S	1,380 yen
40×25	26	26	37	52	52	56	40	ACT402N	1,208 yen	ACT402S	1,380 yen
40×30	31	31	37	57	57	60	40	ACT401N	1,208 yen	ACT401S	1,380 yen
50	46	47	46	82	83	82	20	ACT50N	1,668 yen	ACT50S	1,921 yen
50×20	23	24	46	59	60	65	20	ACT504N	1,610 yen	ACT504S	1,840 yen
50×25	26	27	46	62	63	64	20	ACT503N	1,610 yen	ACT503S	1,840 yen
50×30	31	32	46	67	68	69	20	ACT502N	1,610 yen	ACT502S	1,840 yen
50×40	38	39	46	74	75	72	20	ACT501N	1,610 yen	ACT501S	1,840 yen
NEW 65	52	53	52	93	94	93	10	ACT65N	2,120 yen	ACT65S	2,440 yen
NEW 65×25	28	29	53	68	69	72	18	ACT654N	1,940 yen	ACT654S	2,440 yen
NEW 65×30	33	34	53	73	74	76	16	ACT653N	1,940 yen	ACT653S	2,440 yen
NEW 65×40	40	41	53	80	81	79	14	ACT652N	1,940 yen	ACT652S	2,440 yen
NEW 65×50	46	47	53	86	87	89	12	ACT651N	1,940 yen	ACT651S	2,440 yen

Unit:mm

Eslon AC Drain Pipe and Fittings Product Lineup

45 °Y

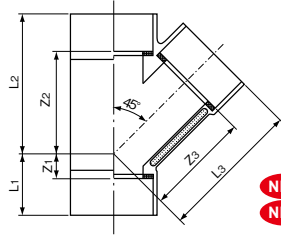

Unit:mm

Nominal Diameter	Effective Length			Full Length			Quantity per Package	Ivory Colored		Transparent	
	Z1	Z2	Z3	L1	L2	L3		No.	Price	No.	Price
30	16	62	66	39	85	89	30	ACY30N	1,495 yen	ACY30S	1,725 yen
40	24	76	82	50	102	108	25	ACY40N	1,610 yen	ACY40S	1,852 yen
50	24	96	102	60	132	138	15	ACY50N	1,725 yen	ACY50S	1,990 yen
50x40	12	84	92	48	120	118	15	ACY501N	1,668 yen	ACY501S	1,921 yen
NEW 65	30	110	119	70	150	161	8	ACY65N	2,190 yen	ACY65S	2,520 yen
NEW 65x50	18	102	110	58	142	146	8	ACY651N	2,120 yen	ACY651S	2,440 yen

<Rigid PVC Injection Molded Product>

Socket

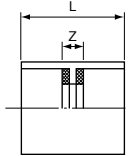
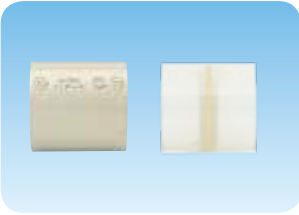

Unit:mm

Nominal Diameter	Effective Length Z	Full Length L	Quantity per Package	Ivory Colored		Transparent	
				No.	Price	No.	Price
20	11	49	120	ACS20N	495 yen	ACS20S	541 yen
25	11	49	240	ACS25N	544 yen	ACS25S	598 yen
30	11	57	160	ACS30N	628 yen	ACS30S	690 yen
40	11	63	80	ACS40N	907 yen	ACS40S	978 yen
50	11	83	40	ACS50N	1,027 yen	ACS50S	1,116 yen
NEW 65	12	92	10	ACS65N	1,300 yen	ACS65S	1,420 yen

Reducing Socket

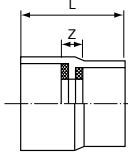
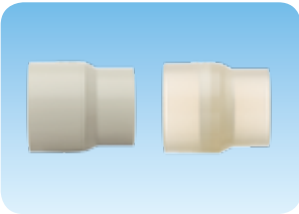

Unit:mm

Nominal Diameter	Effective Length Z	Full Length L	Quantity per Package	Ivory Colored		Transparent	
				No.	Price	No.	Price
25x20	13	51	80	ACS251N	518 yen	ACS251S	564 yen
30x25	12	54	180	ACS301N	628 yen	ACS301S	690 yen
40x30	13	62	100	ACS401N	907 yen	ACS401S	978 yen
50x40	13	75	60	ACS501N	1,027 yen	ACS501S	1,116 yen
NEW 65x50	13	89	10	ACS651N	1,300 yen	ACS651S	1,420 yen

Adapter (Transition Fitting to PVC Pipe)

Nominal Diameters 20, 25

Nominal Diameters 30, 40, 50

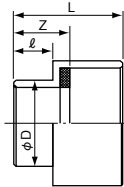
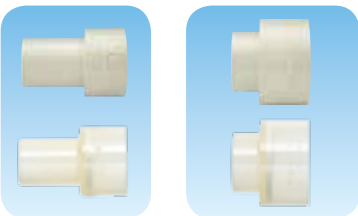

Unit:mm

Nominal Diameter	Effective Length Z	Spigot		Full Length L	Spigot Side Connection Fitting	Quantity per Package	Ivory Colored		Transparent	
		φD	ℓ				No.	Price	No.	Price
20	41	26.0	34	60.0	TS20	100	ACDA20	276 yen	ACA20S	299 yen
25	46	32.0	39	65.0	TS25	80	ACDA25	288 yen	ACA25S	322 yen
30	24	38.0	17	47.5	DV30	80	ACDA30	345 yen	ACA30S	380 yen
40	29	48.0	21	55.0	DV40	50	ACDA40	403 yen	ACA40S	437 yen
50	32	60.0	24	64.5	DV50	30	ACDA50	460 yen	ACA50S	495 yen
NEW 65	45	76.0	37	85.0	DV65	10	ACDA65	590 yen	ACA65S	630 yen

Remarks: 1. Please refer to page 11 for how to use.
2. Connect an AC drain pipe of the same nominal diameter to the socket side. Connect TS fittings to the spigot side with nominal diameters of 20 and 25, and connect DV fittings to the spigot side with nominal diameters of 30, 40 and 50 (as these are for use with DV socket measurements, TS fittings cannot be used).

Dual Conversion Adapter (PVC Pipe VP and Directly Convertible Fittings)

* A PVC TS / DV fitting is not required for PVC pipe conversion.

NEW

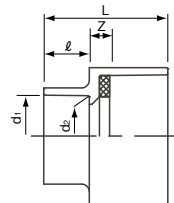
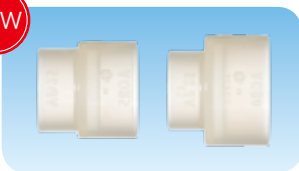

Unit:mm

AC Drain Nominal Diameter	Effective Length Z	Full Length L	VP Socket Size	VP Socket			Quantity per Package	Transparent	
				d1	d2	ℓ		No.	Price
25	8	45	25	32.25	31.85	18	80	ACVP25	450 yen
30	8	49	25	32.25	31.85	18	80	ACVP30	580 yen

MD Fitting Connection Adapter

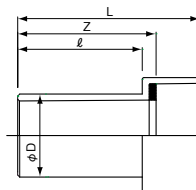
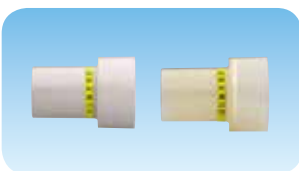

Unit:mm

Nominal Diameter	Effective Length Z	Spigot φD	Full Length L	Spigot Side Connection Fitting	Quantity per Package	Ivory Colored		Transparent	
						No.	Price	No.	Price
40	80	48	72	MDaaa40	25	ACMD40	920 yen	ACMD40S	989 yen
50	84	60	76	MDaaa50	12	ACMD50	1,047 yen	ACMD50S	1,139 yen

Remarks: 1. Connect an AC drain pipe of the same nominal diameter to the socket side. Connect an MD fitting to the spigot side. (Do not connect a TS fitting or DV fitting to the spigot side.)
2. Do not cut the spigot and use.
3. Thermally insulate the spigot part separately.

Expansion Fitting for Vertical Pipe

NEW

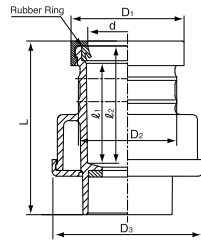

Nominal Diameter	D1	D2	D3	d	L	l1	l2	Quantity per Package	Ivory Colored		Transparent	
									No.	Price	No.	Price
30	69	60	92	48.6	106	61	75	6	ACSS30N	1,830 yen	ACSS30S	2,100 yen
40	85	76	106	60.8	113	62	78	5	ACSS40N	2,510 yen	ACSS40S	2,890 yen
50	106	89	123	77.1	129	67	84	16	ACSS50N	2,830 yen	ACSS50S	3,250 yen
NEW 65	120	114	137	90	132	65	83	12	ACSS65N	3,840 yen	ACSS65S	3,950 yen

Remarks: 1. This is a fitting exclusively for vertical pipes. It cannot be used for horizontal pipes.
2. Please also refer to the construction standards and precautions on page 10.

Unit:mm

Vertical Trap

NEW

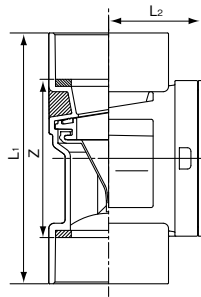

Nominal Diameter	L1	Z	L2	Quantity per Package	Transparent	
					No.	Price
30	147	101	53	40	ACTT340	6,250 yen
40	141	89	53			
50	162	90	53	40	ACTT50	7,500 yen
NEW 65	195	115	53	20	ACTT65	9,000 yen

Remarks: 1. Nominal diameters 30 and 40 are used in combination. When connecting a 30A pipe, fix the supplied conversion adapter to the main unit socket with adhesive.
2. The item with nominal diameter of size 30 connects the conversion adapter to the main unit.
3. Please also refer to the construction standards and precautions on p.10.

Unit:mm



Conversion Adapter

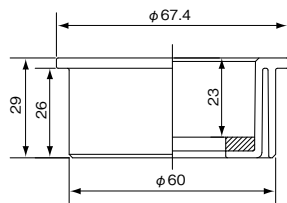

How to use the conversion adapter

When connecting an AC drain pipe with a nominal diameter of 30, connect the supplied conversion adapter to the vertical trap 30-40 A.

⚠ Vertical traps require periodic inspection and cleaning and may need to be replaced. When replacing, use an inspection port unit sold separately.

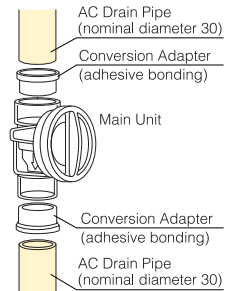

Inspection Port Unit Only (sold separately)

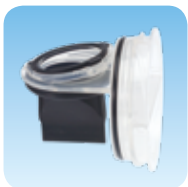

Unit for Testing if the Product is Filled with Water (sold separately)



Upper Part

Product Name	Quantity per Package	Transparent	
		No.	Price
Inspection Port Unit	10	ACTTF35	3,500 yen
Unit for Testing if the Product is Filled with Water	10	ACTTM35	2,780 yen

Remarks: 1. The inspection port unit is set in advance in the vertical trap.
2. The inspection port unit is used when repairing or replacing the unit set in the vertical trap.
3. Testing whether the product is filled with water cannot be performed simply by installing the test unit. A separate water stop jig is required.

Unit:mm

How to Use the Unit for Testing if the Product is Filled with Water

This product is used in exchange for the inspection port unit connected to the vertical trap during the test to see if the product is filled with water.

There is no water stop function in the vertical pipe, so a separate water stop jig (commercially available) is required to perform the test to check if the product is filled with water.

- Turn the inspection port unit counterclockwise to unlock and pull it out.
- Install a unit for testing if the product is filled with water. When installing, make sure that two types of rubber packing (black) are set, and lock it by turning it clockwise while pushing the handle until it is vertical or horizontal.
- After stopping the water in the pipe on the floor below the trap and performing a test to see if it is filled with water, be sure to re-set the inspection port unit removed in (1). At that time, make sure that the two types of rubber packing (black) are set, and there is no abnormality in the self-closing membrane.

(2) Unit to Test if Item is Filled with Water Installation

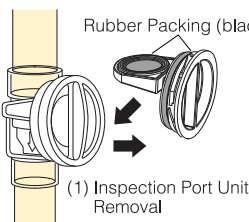

Before test if item is filled with water

(3)-2 Inspection Port Unit Installation

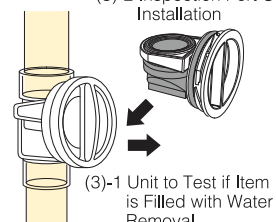

After test if item is filled with water

During test if item is filled with water

⚠ Since the vertical trap has a self-closing membrane, it is not possible to vent the downstream side, so use this product during a test to see if an item is filled with water.

Eslon AC Drain Pipe and Fittings Product Lineup

Related Parts

Screw-Type Cleaning Port (Rigid PVC Injection Molded Product)

Unit:mm

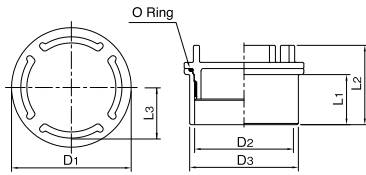

AC Drain Nominal Diameter	D1	D2	D3	L1	L2	L3	Clamp Torque (N·m)	Quantity per Package	Ivory Colored	
									No.	Price
20	41	27	32	19	42.5	17.5	2	200	JNCO25N	350 yen
25	45	32	38	19	41.2	19.5	2	200	JNCO30N	380 yen
30	55	41	48	23	44.5	24.0	4	240	JNCO40N	380 yen
40	68	51	60	26	47.5	29.0	5	132	JNCO50N	440 yen
50	84	69	76	36	57.5	36.0	5	68	JNCO65N	730 yen
NEW 65	98	81	89	41	65.0	42.0	5	48	JNCO75N	1,090 yen

Remarks: 1. Do not use where contacting water continuously, as water condensation may occur.
2. A nominal diameter of one size larger for the AC drain is indicated on the product.

Example of using the screw-type cleaning port: AC drain nominal diameter 50 case

*The nominal diameter of the screw-type cleaning port used is one size larger than the AC drain fitting nominal diameter.

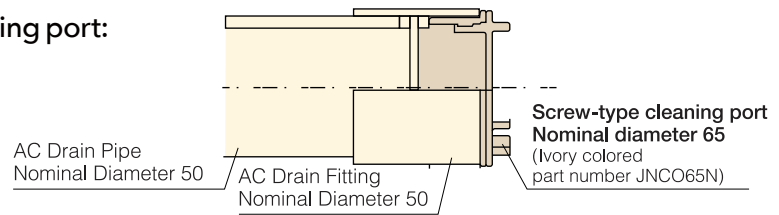

Eslon Adhesive

Please use it as a standard adhesive for AC drain pipe connection.

No.73S Blue
(Colored adhesive)

Capacity:
500g can (with brush)
1kg can (with brush)



No.75S Blue N (Colored
low viscosity type)

Capacity:
500g can (with brush)
1kg can (with brush)



No.73S

Capacity:
500g can (with brush)
1kg can (with brush)



No.75S

Capacity:
500g can (with brush)
1kg can (with brush)



NEW

No.73S UV
(Fluorescent adhesive)

Capacity:
500g can (with brush)



Lights up when checking construction!

The adhesive shines when illuminated with a black light. You can see at a glance whether or not it has been applied even in a dark place, which is useful for confirmation of non-application.

Checking for non-application

Correct adhesive state



State of non-application

- ⚠ Before using No.73S UV, make sure that the color shows.
- ⚠ This is an adhesive for use with drainage. Do not use it for water supply or pressurized pipes.
- ⚠ If it spills on the floor, wipe it up immediately.

*Be sure to use adhesive No.73S Blue, No.75S Blue N, or No.73S UV for transparent AC drain fittings.

AC Drain Cutter

NEW

By cutting the AC drain pipe while turning it, it can be cut without damaging the foam layer.



Standard type
(For nominal diameter 20-50)



Small
(For nominal diameter 20-30)

*Can handle up to a nominal diameter of 50.



**No crushing of the foam layer!
No burrs! Handles nominal diameters of 20-50! No chips!
No diagonal breaks!**

Product Name	Price
AC Drain Cutter (standard type)	37,300 yen
AC Drain Cutter (small)	34,000 yen
Spare Blade	9,200 yen

*The AC drain cutter product is handled by SEKISUI CHEMICAL CO., LTD.

Eslon AC Drain Pipe & Fittings Construction Procedure

Construction Procedure

1 Cut



Mark the part to be cut all around, then cut at right angles to the axis of the pipe using the AC drain cutter or a PVC saw.



- ⚠ Do not use a PVC cutter, etc., as it will cause cracks and fissures.
- ⚠ In the case of a diagonal cut, drain water may enter from the end of the pipe, and there is a risk of water leaking from minute cuts on the outer surface of the pipe.
- ⚠ If there are any scratches, dents or flattened parts on the pipe, cut and remove those parts.
- ⚠ When using an AC drain cutter (shown on page 8), be sure to refer to the accompanying instruction manual. (Handles up to a nominal diameter of 50)



2 Chamfer



Chamfer the threads at the end of the pipe on both the inner and outer surfaces.

- ⚠ If it is not chamfered, the adhesive on the socket will be scraped off when connected, which may cause the thread to come off. So please be sure to chamfer the thread.

3 Cleaning Process



Wipe off with a dry cloth any dirt such as sand, earth, and dust and moisture, etc., adhering to the inside of the fittings socket or the pipe spigot.

4 Record Insertion Length



Record the insertion length shown in the table below in the pipe spigot.

Reference: Insertion length (marked line recorded length) Unit: mm

Nominal Diameter	20	25	30	40	50	65
Insertion Length	19	19	23	26	36	40

5 Application of Adhesive



Apply ESLON adhesive (No.73S Blue, No.75S Blue N, No.73S, No.75S, No.73S UV) evenly to the inner surface of the fittings, the pipe end surfaces and the outer surface of the pipe.

- ⚠ Be sure to use adhesive No.73S Blue, No.75S Blue N, or No.73S UV for transparent AC drain fittings.
- ⚠ Apply adhesive not only to the inner surface of the fittings and the outer surface of the pipe but also to the pipe ends. If the adhesive is not applied, drain water may enter from the pipe end and may leak due to minute cuts on the outer surface of the pipe.

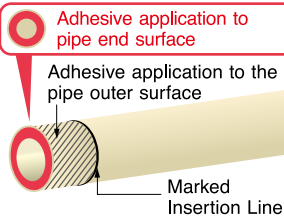

6 Insertion



<Ivory Colored>
Insert as far into the pipe as possible.

<Transparent>
Insert as far into the pipe as possible.

7 Holding (wiping off adhesive, ventilating)



Hold the pipe and fittings until the pipe can no longer come out of the fitting.
(Hold for 30 seconds or more)
Also, wipe off any protruding adhesive with a waste cloth.
Additionally, ventilate the piping thoroughly after installation.

- The outer diameter of the AC drain pipe is the same size as the outer diameter of a PVC pipe that is one caliber larger in nominal diameter, so support brackets for use with the PVC pipe can be used.
- Install the AC drain pipe supports at the same interval as the PVC pipe (VP) of the same nominal diameter.

Installation Procedure for Expansion Fittings for Vertical Pipes

1 Chamfer

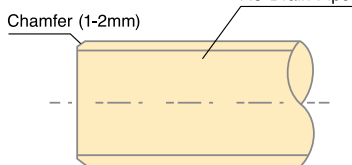

Chamfer the pipe end about 1-2mm.

2 Application of Silicone Sealant

Apply silicone sealant evenly to the pipe end surface.

- ⚠ If it is not applied, drain water may enter from the pipe end and may leak from minute cuts on the outer surface of the pipe.

3 Insertion

Please insert up to the standard insertion length for each nominal diameter in the table on the right.

Nominal Diameter	Insertion Length
30	54mm
40	57mm
50	64mm
65	63mm

Vertical Trap Installation Procedure

1 Inspection Port Unit Removal



Please remove the inspection port unit before installation.

- ⚠ If the trap is installed without removing it and the adhesive sticks to the inspection port unit, it may not work.

2 Adhesive Bonding

Bond to the AC drain pipe with adhesive.

3 Inspection Port Unit Installation



Attach the removed inspection port unit. When installing, while pushing the handle until it is vertical or horizontal, turn it clockwise to lock it.

Horizontal Pipe Installation Standard

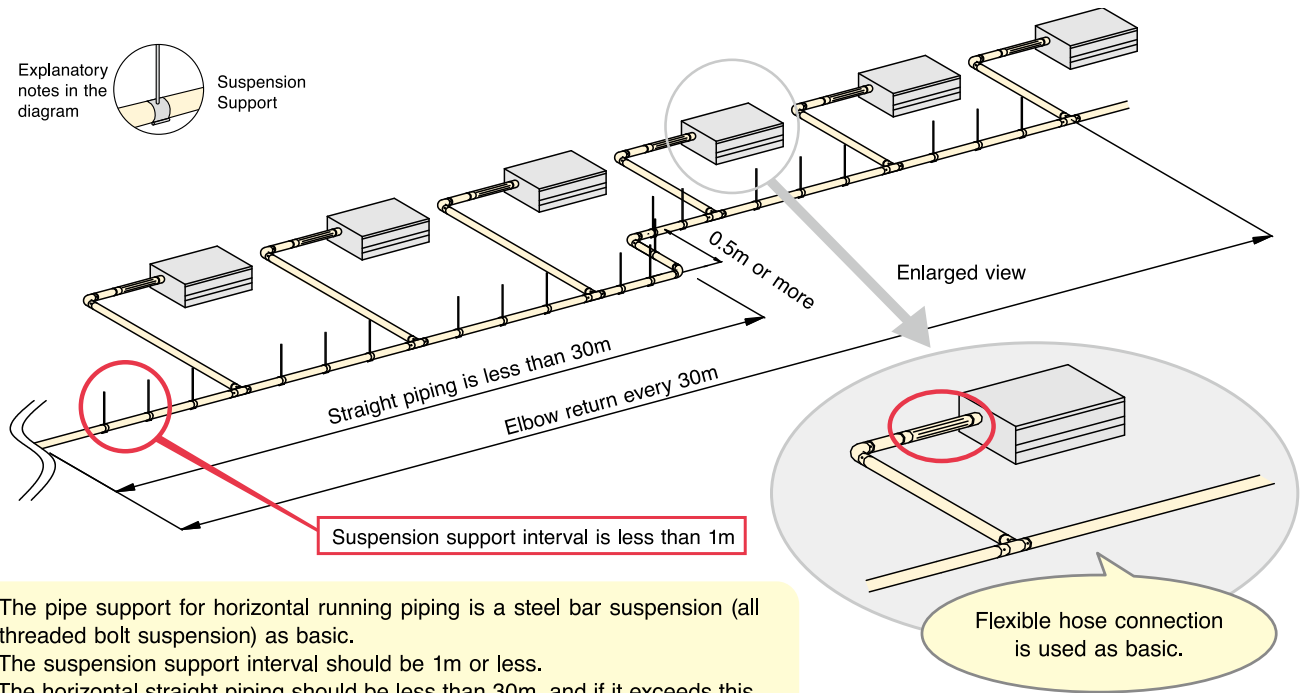

- The pipe support for horizontal running piping is a steel bar suspension (all threaded bolt suspension) as basic.
- The suspension support interval should be 1m or less.
- The horizontal straight piping should be less than 30m, and if it exceeds this, return the elbow every 30m (2 elbows or more, elbow interval 0.5m or more).

Vertical Pipe Installation Standard

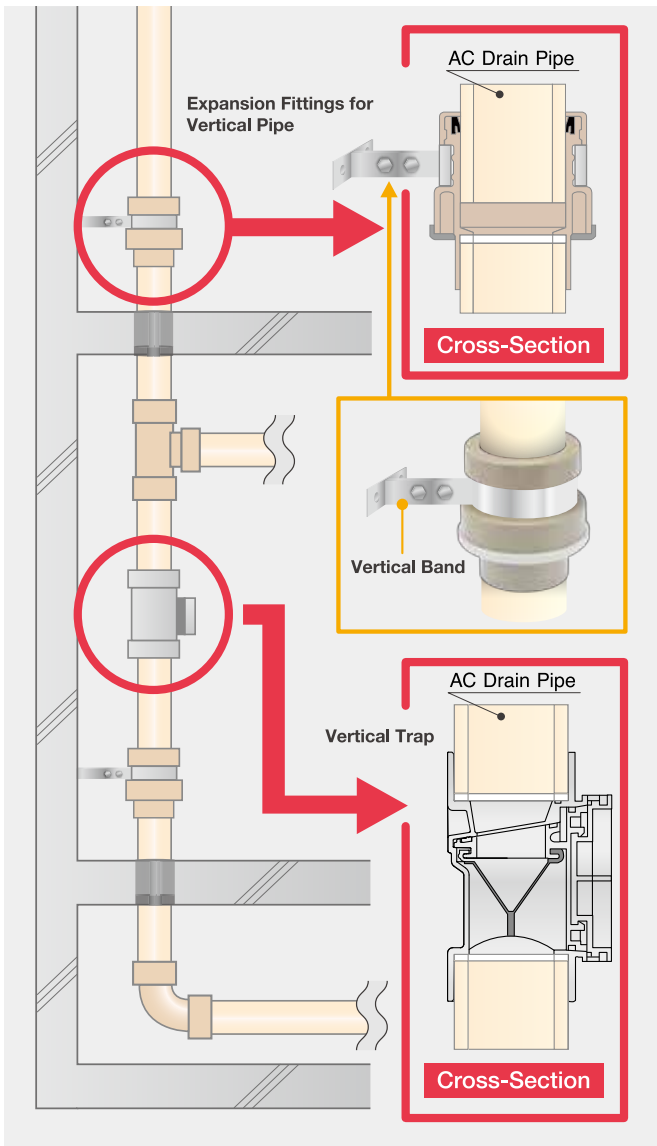

Common precautions for the vertical pipe expansion fittings and vertical traps

- This product is a fitting exclusively for vertical pipes. Do not use it for horizontal pipes.
- The direction of the arrow on the main unit is the direction of flow of the drain water. Install the pipe with the arrow in the downward direction.
- When connecting, chamfer (deburr) the inner and outer surfaces of the pipe end.
- Remove any foreign matter adhering to the pipe or packing.
- When inserting the pipe into the fitting, do not insert it with force, such as oblique insertion or hammering.
- After installation, be sure to run water through the pipe and check that water flows.

Expansion Fittings for Vertical Pipe

Installation Standard

- Install the expansion fittings on the slab at one place on each floor.
- If the pipe is not fixed to the penetration part and has no junction, install one expansion fitting every 10 m.
- Support the expansion fittings and directly under the expansion fittings.

Installation Precautions

- Application of lubricant is not required for the rubber ring part.
- Insert the AC drain pipe to the specified insertion length.
- Apply silicone sealant to the end surface of the pipe that is inserted upstream of the expansion fittings for vertical pipes.

Nominal Diameter	Insertion Length
30	54mm
40	57mm
50	64mm
65	63mm

Vertical Trap

Installation Standard

- The installation height (H) of the air conditioner and this product should be 50mm or more. However, the installation height (H) is required to be in accordance with the internal static pressure (negative pressure) of the connected air conditioner. $H [mm] = \text{Internal static pressure (negative pressure)} [Pa] \div 9.8 [Pa / mmAq] + 50 [mm]$
- This product requires periodic inspection and cleaning, and may require replacement. Provide sufficient space around the product for maintenance.

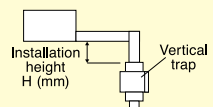

Installation Precautions

- Please attach this product to the AC drain pipe using an ESLON adhesive. Be careful of dripping due to excessive application of adhesive. If the adhesive sticks to the self-closing film, it may not work, so remove the inspection port unit before the parts are attached together with adhesive.
- When using the conversion adapter (30A), attach it to the main unit with an ESLON adhesive.

Connection Method with Different Types of Pipes

When connecting different types of pipes, be sure to use an adapter fitting at the end of the AC drain pipe.

(1) When connecting VP pipes (TS joints) of nominal diameters 20 and 25 to AC drain pipes

Connect the adapter fitting and TS fitting in combination.

⚠ The VP pipe and TS fitting require separate thermal insulation.

*This can also be used when connecting to a drain hose.

<25 Case>

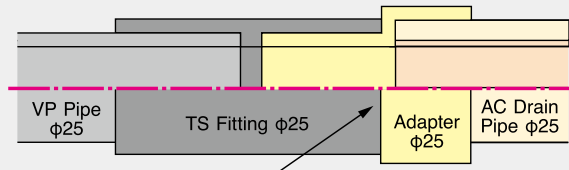

TS socket with the same nominal diameter

(2) When connecting VP pipes (DV fittings) of nominal diameters 30, 40, 50 and 65 to AC drain pipes

Connect adapter fittings and DV fittings in combination.

⚠ The VP pipe and DV fitting require separate thermal insulation.

⚠ Since the spigot is the size of the DV socket, it cannot be connected to TS fittings.

<50 Case>

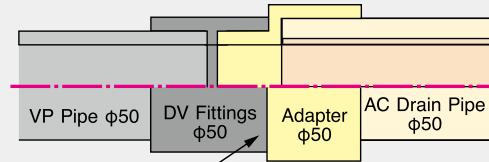

DV socket of the same nominal diameter

(3) When connecting MD fittings and the AC drain pipe

Connect using the MD fitting adapter.

⚠ Do not cut the spigot and use it.

⚠ Do not connect TS fittings or DV fittings to the spigot side.

⚠ The MD fitting adapter spigot part and the MD fittings require separate thermal insulation.

<40 Case>

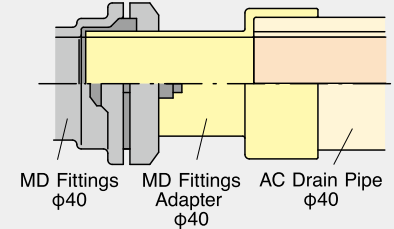

Eslon AC Drain Pipe and Fittings Performance

<< Design >>

● Condensation prevention performance, nominal diameter 25, pipe slope 1/50 case

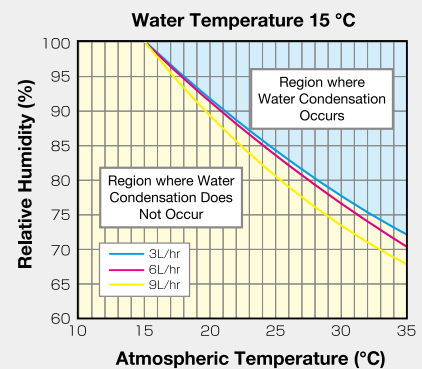
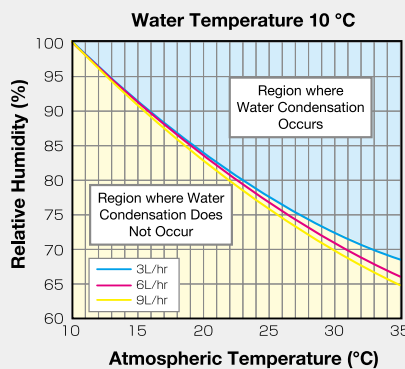
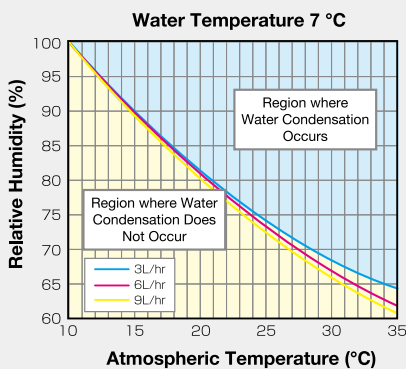

⚠ Performance of AC drain pipe and fittings when using horizontal pipe.

When using an AC drain pipe and fittings for a full pipe such as an upwardly draining part, as a general rule, provide separate thermal insulation.

⚠ Usage Precautions

1. Precautions Based on Design

- ⚠ This is a dedicated pipe for air conditioner drain piping. Never use it for pressurized pipe applications other than an upwardly draining section (1m or less).
- ⚠ In the section of inner pipe of an upwardly draining section that fills with water, water condensation may occur in the AC drain pipe and fittings single unit, so as a general rule, thermally insulate them separately.
- ⚠ This is a pipe for indoor use only. Do not use outdoors.
- ⚠ In places where the fire protection section is penetrated, fire protection section penetration handling is required using Fiblock.
- ⚠ The pipe support for horizontal running piping is a steel bar suspension (all threaded bolt suspension) as basic.
- ⚠ Horizontal straight piping should be less than 30m, and if it exceeds this, return the elbow every 30m (2 elbows or more, elbow interval 0.5m or more).
- ⚠ For a vertical pipe, handle stretching using an expansion fittings for use with vertical types at one place on each floor.
- ⚠ Under the following operating environment conditions, there is a risk of condensation on the AC drain pipe and fittings. Check the operating conditions and environmental conditions.
 - In an environment where outside air flows in, the environment around the piping is also easily affected by the outside air, which may result in temperature and humidity conditions that cause condensation.
 - In places where high temperatures and high humidity are expected even indoors (under a roof, near an outer wall, etc.), the environment around the piping may be easily affected, which may result in temperature and humidity conditions that cause condensation.
 - There is a risk of condensation in drainage water that flows at a high rate (for example, drained water from the air handling unit).

2. Storage Precautions

- ⚠ Install the AC drain pipe support at the same interval as the PVC pipe (VP) of the same nominal diameter.
- ⚠ Be sure to store the pipes and fittings indoors. When storage outdoors is unavoidable, in order to avoid direct sunlight, please use some method to ensure that they are not confined in hot air such as covering with a sheet.
- ⚠ Do not use fire in the storage area. Pipes and fittings may deteriorate due to sparks or heat.
- ⚠ Do not place solvent or paint in the storage area. If an organic solvent adheres to the pipes or fittings, they may deteriorate.

3. Transportation Precautions

- ⚠ Since the AC drain pipe has a foam layer which is soft, the packaging specification requires cardboard packaging over the full surface. Even more care should be taken when handling than with PVC (VP) pipes. Never drag or throw, etc.

4. Precautions for Installation of AC Drain Pipe and Fittings

- ⚠ Please use Eslon adhesives No.73S Blue, No.75S Blue N, No. 73S, No. 75S or No.73S UV.
- ⚠ Be sure to use adhesives No.73S Blue, No.75S Blue N, or No.73S UV for transparent AC drain fittings. Be sure to follow the installation procedure (P.9) in the Eslon AC drain pipe and fittings catalog.
- ⚠ The connection between the AC drain pipe and the DV fittings (TS fittings) for PVC pipes may cause accumulation of water or condensation due to steps in the pipe, so please observe the following items
 - Be sure to use an AC drain pipe and AC drain fittings in combination for the AC drain piping system.
 - When connecting an AC drain pipe and a PVC pipe, use an adapter fitting (see page 5).

5. Precautions for Installation of Expansion Fittings for Vertical Pipes

- ⚠ Since the direction of the arrow on the main unit indicates the direction of drain water flow, install with the arrow pointing downwards.
- ⚠ Chamfer (deburr) the inner and outer surfaces of the pipe end.
- ⚠ Application of lubricant is not required.
- ⚠ Remove any foreign matter from the tube or packing.
- ⚠ Insert the specified amount of the AC drain pipe.

Nominal Diameter	Insertion Length
30A	54mm
40A	57mm
50A	64mm
65A	63mm

- ⚠ Do not insert forcefully, such as inserting diagonally or hammering.

6. Precautions for Installation of Vertical Trap

- ⚠ Since the direction of the arrow on the main unit indicates the direction of drain water flow, install with the arrow pointing downwards.
- ⚠ Join this product with an AC drain pipe using an ESLON adhesive.
- ⚠ Please beware of dripping due to excessive application of adhesive. If the adhesive sticks to the self-closing film, it may not work, so remove the inspection port unit before applying the adhesive.
- ⚠ After installation, be sure to check the operation of the self-closing film and check that water flows.

7. Other Precautions

- ⚠ If there are any scratches, dents or flattened parts on the pipe, cut and remove those parts.
- ⚠ If the pipe or fittings touch organic solvents such as creosote, asphalt, preservatives, waterproofing agents, ketones, castor oil or glycol ethers, they may swell and break, so do not apply or put these solvents in contact with the pipe or fittings.
- ⚠ Do not flush with chemicals such as solvents, ethanols, chlorinates, glycol ethers, or castor oil. The pipeline may be damaged and water leakage may occur. Be especially careful when cleaning the inside of the air conditioner body with liquid chemicals.
- ⚠ Do not step on or hang from the pipe.
- ⚠ Keep away from fire such as electric welding sparks, and in torch lamps and gas burners.
- ⚠ For the separation distance between gas appliances such as gas water heaters and the surrounding piping, please observe the standards stated in the gas equipment installation standards and practical guidelines (Japan Gas Appliances Inspection Association). In addition, since the standard may be relaxed depending on the model of the gas water heater, check with your gas company or gas equipment manufacturer for the specific separation distance.
- ⚠ Do not place pipes near open flames such as gas stoves.

⚠ Precautions

If the amount of adhesive used per hour exceeds the permissible amount indoors, the "Organic Solvent Poisoning Prevention Rules" will apply and you will need to be qualified as an "Organic Solvent Handling Manager". For details, check with your local Labour Safety Standards Inspection Office.

- ⚠ Since organic solvents such as adhesives are used during installation, be careful not to cause a fire.
- ⚠ When using an adhesive, be sure to provide adequate ventilation. If you get adhesive on your skin, remove it immediately. If you feel unwell or that you have something wrong physically, consult a doctor immediately.
- ⚠ In sealing materials used when piping penetrates the building foundations, walls, floors, etc., there are substances (for example, polyurethane sealants) that include plasticizers (phthalate ester, DOP, etc.) and organic solvents (xylene, toluene, etc.) that may adversely affect AC drain pipes and fittings. Do not use sealing materials containing these components as they may adversely affect PVC pipes and fittings. (Recommended products: Silicone Sealant made by Sekisui Fuller Co., Ltd, Modified Silicone Sealant)
- ⚠ Do not allow the pipe and fittings to contact directly with the covered wire (cord / covered support metal and vinyl tape) containing the plasticizer as it may immerse the pipe and fittings.
- ⚠ Please contact your nearest sales office regarding usage other than that described in this document.
- ⚠ When performing a test to check if an item is filled with water, be sure to carry it out with a hydraulic head of 3m (30kPa) and pay attention to the following items."
 - Note that if there is uneven application of the adhesive at the pipe end or if there is a gap between the fittings and the pipe, then water may enter from the pipe end.
 - When a test to check if an item is filled with water is performed, be sure to visually check and touch the connecting part.



<https://eslontimes.com/en>

* Colors of the actual products may vary from the colors shown in this printed material.
* Information in this document is subject to change without notice.

All rights reserved.

Dec. 2019 4th Edition

ESLON AC Drain Pipe and Fittings
Catalog

SEKISUI CHEMICAL CO.,LTD.
Urban Infrastructure &
Environmental Products Company

No. 05959

2020. 7. 5HU TX

Rigid PVC Pipe and Fittings with anti water condensation layer for air conditioning drainage

ESLON™ AC DRAIN Series

ESLON™

AC DRAIN Flexible unit

Ideal for the drain-up section of AC DRAIN piping!

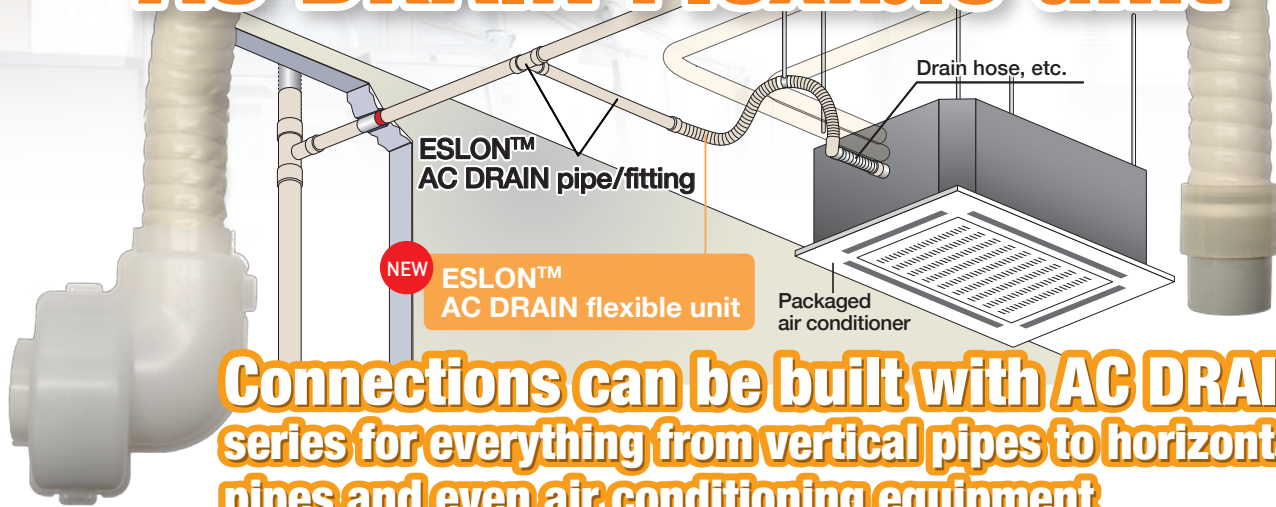

Connections can be built with AC DRAIN series for everything from vertical pipes to horizontal pipes and even air conditioning equipment

POINT 1 The insulating cover has a one-touch construction, eliminating the need for troublesome tape winding!

● Insulation of equipment side fittings can be significantly simplified.

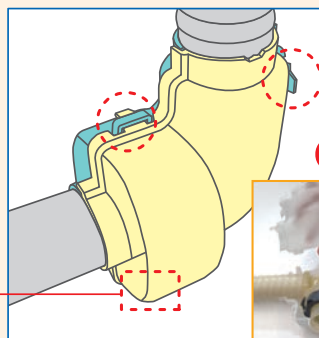
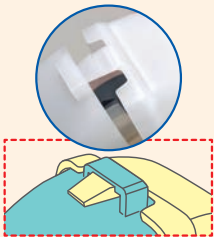

One-touch method of closing 3 tabs

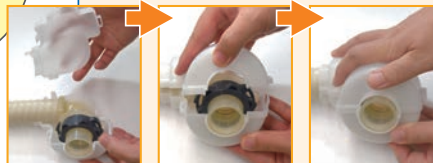

● Insulate the air layer by attaching an insulating cover.
※ When connecting the VP pipe, separate insulation is required for the VP section.

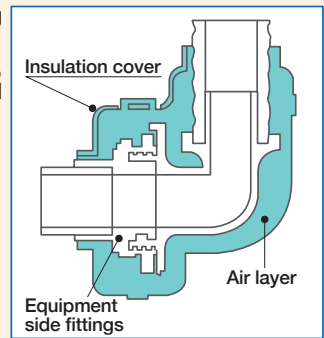

POINT 2 Equipment side fittings can be attached and detached without tools during inspection and maintenance!

● The nut spurs can be attached and detached by pushing down.



Click!

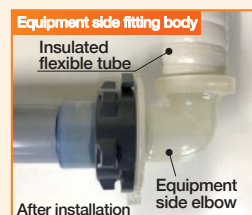

POINT 3 The piping side fittings support various piping forms!

● By selecting the spigot and socket type depending on the type of piping form, the number of on-site connections is reduced, construction becomes faster, and the need for insulation is eliminated.

● We have a lineup of two types of hose lengths, 700 mm and 1,000 mm.

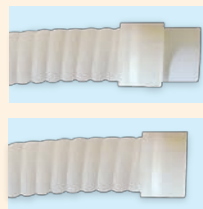

Spigot-type
(AC DRAIN pipe is connected in advance)

Receptacle type
(AC DRAIN socket nominal diameter 25 mm)



AC DRAIN disconnection and connection work can be omitted and can be directly connected to the fitting

Other features

With a combination of support brackets and pipe support members, workability of the drain-up part is further improved!

If the ceiling hanging bracket cannot be used, continuous thread orthogonal brackets, piping support members and continuous thread studs (commercially available) can be used.

Continuous thread orthogonal brackets

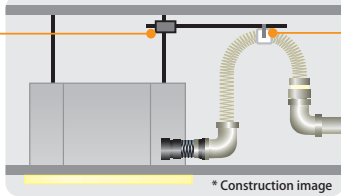

Piping support member

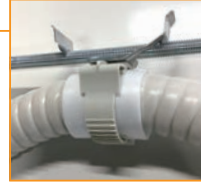

A transparent fitting allows visual confirmation

Visual confirmation of adhesive connection is possible in combination with colored adhesive. Also, water flow can be confirmed on the equipment-side elbow.

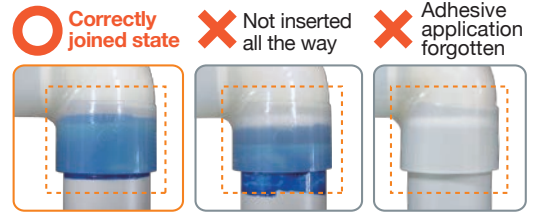

* The above photo is an example of using Adhesive No.73S Blue.

AC DRAIN flexible unit lineup

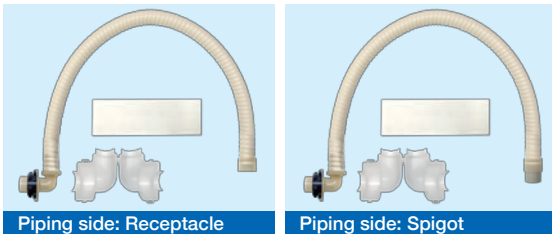

Diameter	Piping side	Length (mm)	Product number	Quantity (units/box)
25A	Receptacle	700	ACF257U	10
		1000	ACF25HU	10
	Spigot	700	ACF257S	10
		1000	ACF25HS	10

Receptacle type

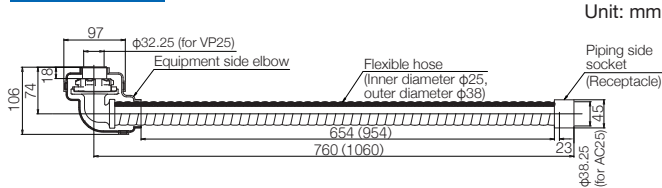

Spigot type

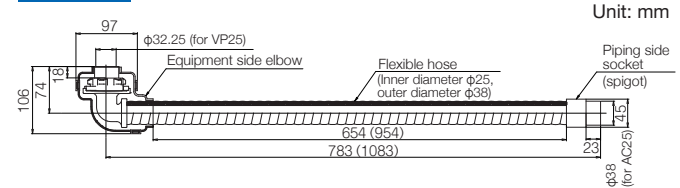

Support bracket lineup

Continuous thread orthogonal brackets

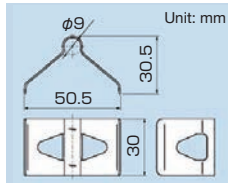

Piping support member

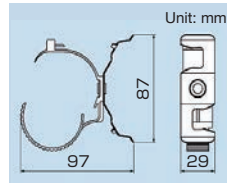

Type	Product number	Quantity (pieces/box)
Continuous thread orthogonal brackets	ACFVF	100
Piping support member	ACFHSB	100

⚠ Precautions for using the AC DRAIN flexible unit

- Dedicated to drain-up piping for commercial air conditioners. Please do not use it for other purposes.
- Do not pull or bend the fitting on the fulcrum.
- The minimum bending radius of the insulating flexible pipe should be at least 110 mm.
- Do not apply excessive force to the fitting connection part.
- When standing up the AC DRAIN flexible unit from the air conditioner, refer to the instruction manual of the air conditioner manufacturer. Be careful not to stand up more than the capacity of the machine.
- When connecting to the air conditioner connection port, check the specifications of the air conditioner manufacturer before connecting.
- Do not flush chemicals (surfactants, organic solvents, acids, alkalis, etc.) or solids other than air-conditioned drain water.
- For actual construction, be sure to refer to the enclosed construction manuals and the catalog and technical data of ESLON™ AC DRAIN pipe/fitting.

SEKISUI CHEMICAL CO., LTD. Building & Pipe Systems Division

2-10-4 Toranomon Minatoku, Tokyo, 105-8566 Japan TEL +81-3-6748-6489 FAX +81-3-6748-6553

SEKISUI SINGAPORE PTE. LTD.

7500A Beach Road, #12-306 The Plaza, Singapore 199591 TEL +65 6296 3788

ESLON TIMES
https://eslontimes.com/en/

No. 05964

2022.7.0TH TX



SINGAPORE GREEN BUILDING PRODUCT CERTIFICATE

AWARDED TO

Sekisui Singapore Pte Ltd

7500A Beach Road, #12-306 The Plaza
Singapore Singapore 199591

FOR THE PRODUCT

Pipe & Fittings - Non-Potable Water

PRODUCT BRAND

ESLON

PRODUCT MODEL

AC Drain Pipe (ACD20P, ACD25P, ACD30P, ACD40P, ACD50P), 90 Degree Elbow (ACL20N, ACL25N, ACL30N, ACL40N, ACL50N, ACL20S, ACL25S, ACL30S, ACL40S, ACL50S), 45 Degree Elbow (AC4L20N, AC4L25N, AC4L30N, AC4L40N, AC4L50N, AC4L20S, AC4L25S, AC4L30S, AC4L40S, AC4L50S), Tee Fitting (ACT20N, ACT25N, ACT30N, ACT40N, ACT50N, ACT251N, ACT302N, ACT301N, ACT403N, ACT402N, ACT401N, ACT504N, ACT503N, ACT502N, ACT501N, ACT20S, ACT25S, ACT30S, ACT40S, ACT50S, ACT251S, ACT302S, ACT301S, ACT403S, ACT402S, ACT401S, ACT504S, ACT503S, ACT502S, ACT501S), 45Y (ACY30N, ACY40N, ACY50N, ACY501N, ACY30S, ACY40S, ACY50S, ACY501S), Socket (ACS20N, ACS25N, ACS30N, ACS40N, ACS50N, ACS251N, ACS301N, ACS401N, ACS501N, ACS20S, ACS25S, ACS30S, ACS40S, ACS50S, ACS251S, ACS301S, ACS401S, ACS501S), Adapter (ACDA20, ACDA25, ACDA30, ACDA40, ACDA50, ACA20S, ACA25S, ACA30S, ACA40S, ACA50S), MD Adapter (ACMD40, ACMD50, ACMD40S, ACMD50S), Connecting Fitting Adaptor (ACMD40, ACMD50), Clean out (JNCO25N, JNCO30N, JNCO40N, JNCO50N, JNCO65N)



THE PRODUCT HAS BEEN ASSESSED ACCORDING TO THE ASSESSMENT CRITERIA OF SINGAPORE GREEN BUILDING PRODUCT CERTIFICATION SCHEME. IT HAS BEEN AWARDED THE RATING:

A handwritten signature in black ink, appearing to be "M. S.", is positioned above a horizontal line.

Director
SGBC Pte Ltd



Certificate Number	Original Issue Date	Revised Date	Valid Till
SGBP 4149	10 August 2023	-	09 August 2025

✓Good ✓✓Very Good ✓✓✓Excellent ✓✓✓✓Leader

The use and reliance on this certificate is subject to the terms and conditions of the Singapore Green Building Product Certification Scheme. Revised certificates may also be issued at the discretion of the Council. The certification status may be verified at the Singapore Green Building Council website (www.sgbc.sg).

