

ESLON VU/AE SCREW CAP

COMPLY WITH JIS K 6739

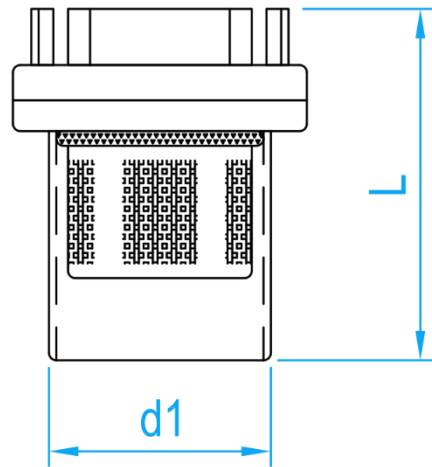
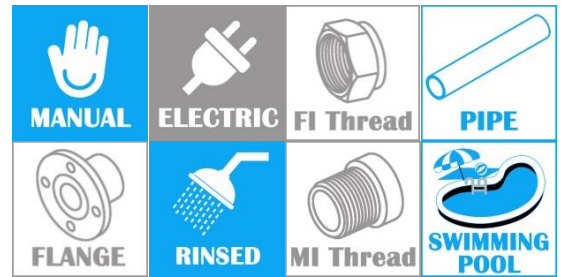

CROSS SECTIONAL VIEW

DIMENSIONS

SKU	DN	d1 (mm)	L (mm)	WEIGHT (Kg)	PCS/CTN
AESC042	42	23.85±0.3	44.25	0.058	240
AESC050	50	30.20±0.3	47.83	0.072	132
AESC065	65	37.81±0.3	58.23	0.128	68
AESC080	80	44.30±0.3	65.55	0.180	48
AESC100	100	56.80±0.4	76.80	0.287	24
AESC125	125	69.81±0.4	98.01	0.561	10
AESC150	150	82.19±0.5	117.20	0.902	6

- Notes:**
1. This product is injection molded.
 2. Out of the scope of the AS38 standard.