

## [THREAD END] COMPACT BALL VALVE

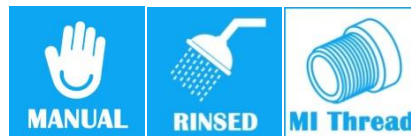

- END CONNECTOR: THREAD
- WORKING PRESSURE: 150PSI

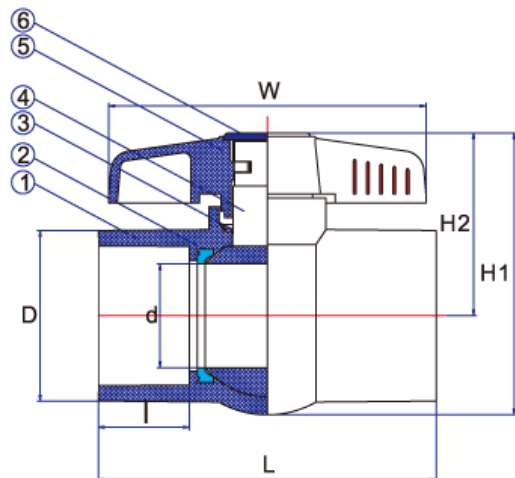

BVAWE015T-BVAWE050T

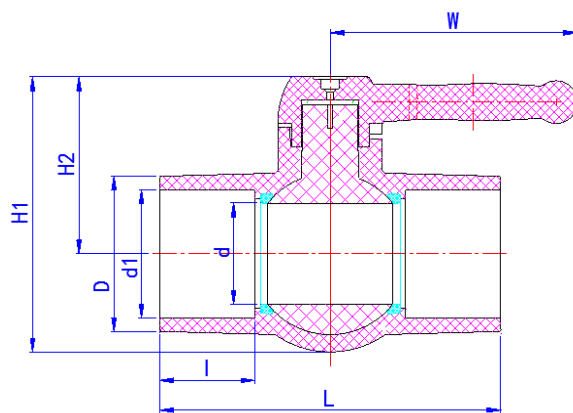

BVAWE065T-BVAWE150T

### COMPONENT PARTS

ITEM	PARTS	MATERIAL	QTY
1	Body	PVC, CPVC, PP	1
2	Seat Seal	TPE, PTEE	2
3	O-Ring	EPDM, FPM(NBR)	1
4	Ball	PVC, CPVC, PP	1
5	Handle	ABS	1
6	Cap	ABS	1

### DIMENSIONS

SKU	NPT Thd./in	BSPT Thd./in	JIS d1(mm)	BS d1(mm)	ANSI d1(mm)	DIN d1(mm)	d (mm)	D (mm)	L (mm)	I (mm)	W (mm)	H1 (mm)	H2 (mm)	WEIGHT (kg)	PCS/ CTN
BVAWE015T	14	14	22	22	21.34	20	14.5	32.0	80.0	22.0	68.5	64.3	44.9	0.087	162
BVAWE020T	14	14	26	26	26.67	25	20.0	36.8	92.0	25.0	80.5	76.0	52.0	0.133	80
BVAWE025T	11.5	11	32	34	33.40	32	24.0	45.0	106.0	28.0	100.0	94.0	65.0	0.229	84
BVAWE035T	11.5	11	38	42	42.16	40	30.0	53.5	112.5	28.0	108.0	103.0	70.0	0.308	50
BVAWE042T	11.5	11	48	48	48.26	50	34.0	62.0	129.0	33.0	108.0	112.0	73.5	0.434	50
BVAWE050T	11.5	11	60	60	60.33	63	44.0	75.5	148.0	39.5	138.0	126.0	81.0	0.671	24
BVAWE065T	8	11	76	76	73.00	75	56.0	92.5	178.5	39.5	161.9	102.4	160.0	1.324	18
BVAWE080T	8	11	89	89	88.90	90	71.0	107.0	209.0	48.0	161.9	112.7	178.7	1.699	2
BVAWE100T	8	11	114	114	114.30	110	86.0	134.5	294.0	78.0	216	153.5	238.5	3.936	1
BVAWE150T	/	/	/	/	168.8	160	130.4	185.4	407.0	102.7	301.9	299.5	181.2	8.860	1