

PPR PIPES & FITINGS

PPR FI TEE

Colour- Green

Type of metal - DZR Brass

COMPLY WITH ISO 15874-2, 3 & 5

SS 375

AS/ NZS 4020

BS EN 12165

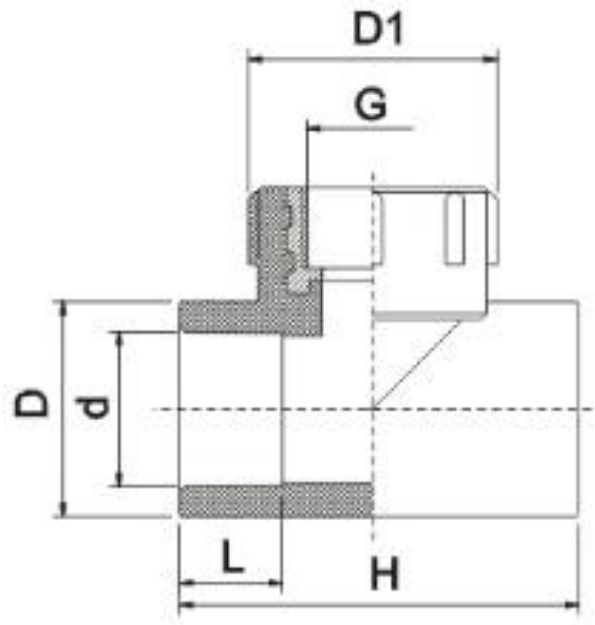

DIMENSIONS

SKU	D (mm)	d (mm)	L (mm)	G (mm)	H (mm)	D1 (mm)	Weight (kg)	PCS/CTN
PPRFIT02015	27.4	19.0	16.1	½"	56.0	43.6	0.070	160
PPRFIT02020	27.8	19.0	16.2	¾"	62.0	47.0	0.092	120
PPRFIT02515	34.8	24.0	18.1	½"	64.2	44.0	0.084	120
PPRFIT02520	34.8	24.0	18.1	¾"	64.2	49.0	0.105	100
PPRFIT03215	42.8	30.4	20.2	½"	70.0	46.4	0.114	80
PPRFIT03220	42.4	30.4	20.1	¾"	76.0	49.0	0.125	70
PPRFIT03225	42.8	30.4	20.6	1"	81.2	64.5	0.242	50